

Q	Expansion anchor bolt (M8 X 80)	2
R	M5X10 screw	8
S	Hexagon screw (M6 X 16)	1

4.1.2 Optional package

Parallel Connection Package (used for the connection between the stackable battery each other, product code LBP334-000350-00)

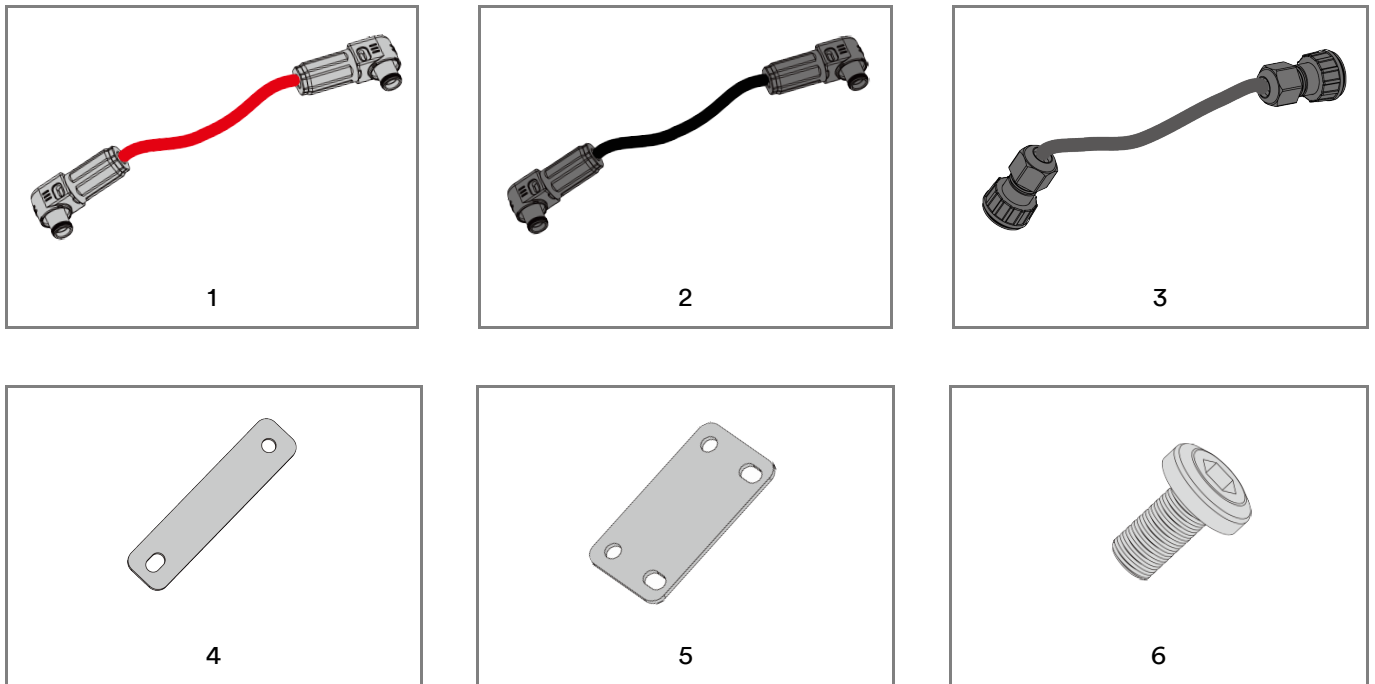

Output Cable(3m) Package (used for the double power connection between the battery system and the hybrid, product code LBP334-000354-00)

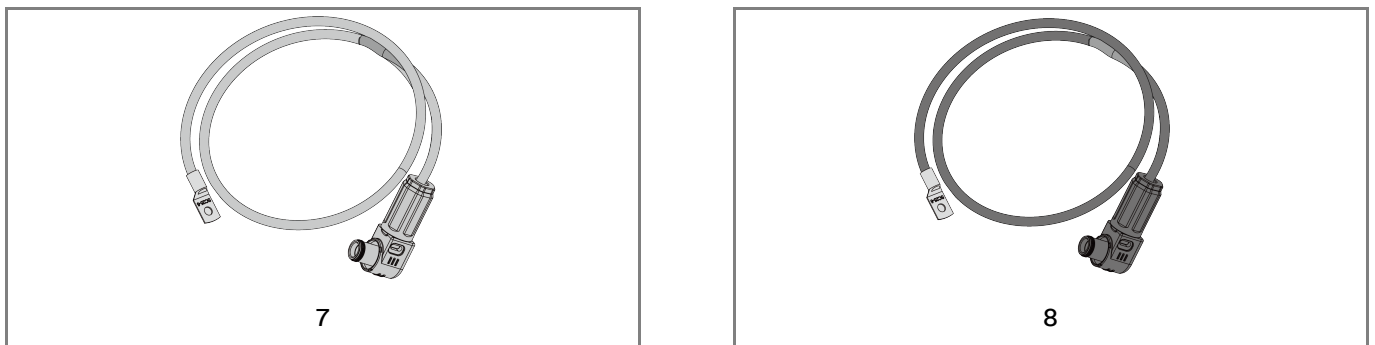

Wall Mounting Optional Package (product code:LBP335-000076-00)

