

Power ™

WHISPR-7



QUICK-START
INSTALLATION GUIDE



- This document is subject to change from time to time due to product upgrades or other reasons. This document is not a substitute for the user manual or safety instructions.
- Please read the user manual and related standards before undertaking any operation or commissioning. Please take time to access <http://www.powerplus-energy.com.au> or scan the QR code for the latest quick installation guide.
- Prior to commencement, check whether the goods match the packing list, if there is any damage to any items or components missing, please contact your Distributor / Dealer or PowerPlus Energy.
- The power cables must be intact and well insulated. Please use insulating gloves and wear personal protective equipment at all times when installing this product.
- Failure to comply with any of the above requirements may result in injury to personnel or damage to equipment.

PowerPlus Energy shall not be liable for any loss of life or damage caused by failure to comply with the requirements of this document and user manual.

Safety Statement

Danger

- Shock hazard !
- Exposure to sunlight and the elements are not recommended.
- All electrical connections must meet local and national electrical standards.
- Only connect the system to the grid with local authority approval .
- Warranty will be void if the cover is removed. Improper opening of the unit may also result in serious electrical shock or injury to personnel.

Warning

All safety labels, warning labels, and nameplates must be clear and visible and cannot be removed or overwritten.

Warning

Hot surface!
Inverter module may become hot after extended period of operation. Allow time for inverter to cool before touching!

Notice

The country setting and protection parameters must be set by professional personnel based on local power grid standards.
Incorrect country settings may affect the operation failure to meet the local standard.

Warning Label



Disconnect all external power supplies before maintainace.



Hot surfaces !



Device has high voltage on AC input and AC output. Professional and qualified technicians are required to install this unit.



Read the instructions before operation.



Wait for 5 minutes before touching the internal conductive components after system turn off and disconnected from grid.

Packing List

RX-7013Plus Standard Accessories



RX-7013Plus

(1PCS)

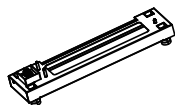

Base Components

(1PCS)



Side cover(right)

(1PCS)



Side cover(left)

(1PCS)

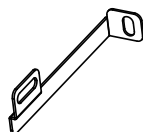

PCS bracket A

(1PCS)

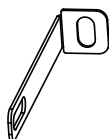

PCS bracket B

(1PCS)

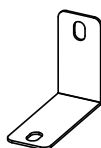

Base bracket

(2PCS)

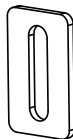

Battery Connecting buckle

(2PCS)

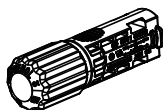

PV output connector

(3PCS)

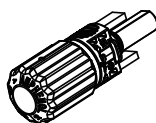

PV input connector

(3PCS)



RJ45 waterproof plug

(4PCS)

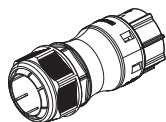

Generator

(2PCS)

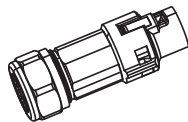

Grid Connector

(1PCS)

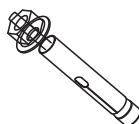

Expansion Bolts

(4PCS)

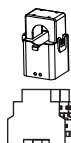

Smartmeter+CT
(Optional)

(1PCS)



WI-FI/4G Dongle
(Optional)

(1PCS)



PV Tools

(1PCS)

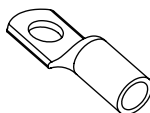

SC6-6

(1PCS)



Document

(4PCS)

Dimension

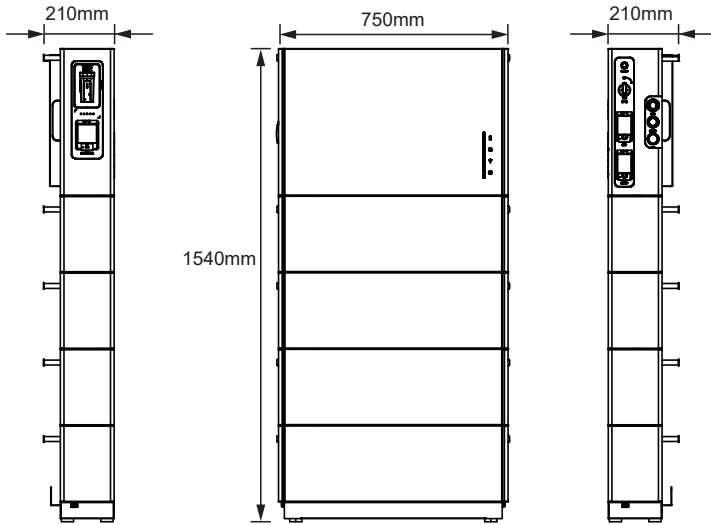

Installation Location

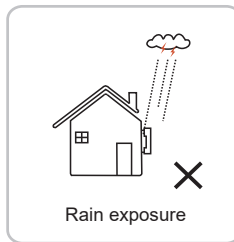
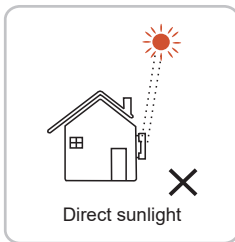
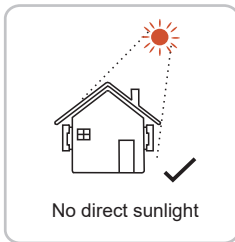

Pre - Operation Inspection

	Checking Items	Result	
		YES	NO
①	The installation location meets the manual & standard's requirements.	<input type="checkbox"/>	<input type="checkbox"/>
②	The system has been securely installed.	<input type="checkbox"/>	<input type="checkbox"/>
③	Sufficient space for heat dissipation. No objects are left in or on the system.	<input type="checkbox"/>	<input type="checkbox"/>
④	System wiring is connected and tightened.	<input type="checkbox"/>	<input type="checkbox"/>
⑤	Cables are properly installed and well protected without any damage.	<input type="checkbox"/>	<input type="checkbox"/>
⑥	All terminals have been sealed.	<input type="checkbox"/>	<input type="checkbox"/>
⑦	Warning labels are not covered without alteration or occlusion.	<input type="checkbox"/>	<input type="checkbox"/>

Operation

Following the steps to start the system.

Step① : Connect 240V grid to inverter (if Grid available).

Step② : Connect PV to MPPT ports.

Step③ : Turn on the battery isolation circuit breaker.

Step④ : Turn on the inverter power button.

Step⑤ : Open the Redx Power App, complete all Installation steps in the App.

Installation

Avoid water and electricity when drilling, bit size $\phi 8\text{mm}$, drilling depth 40mm.

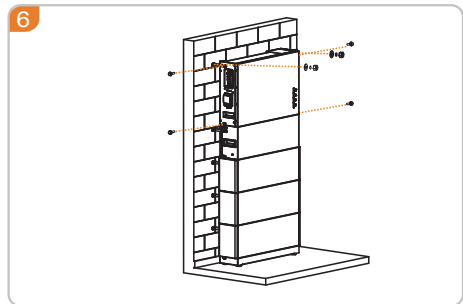
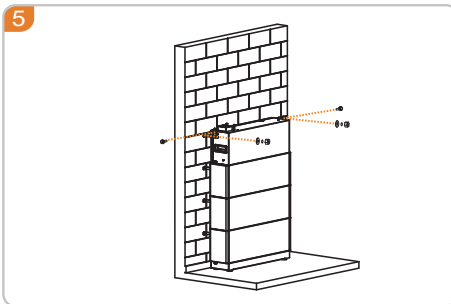
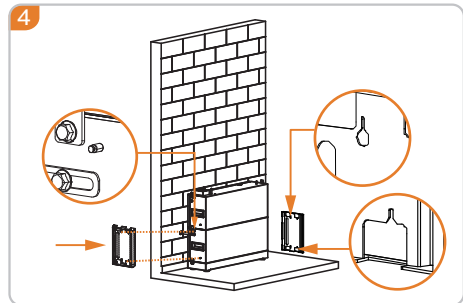
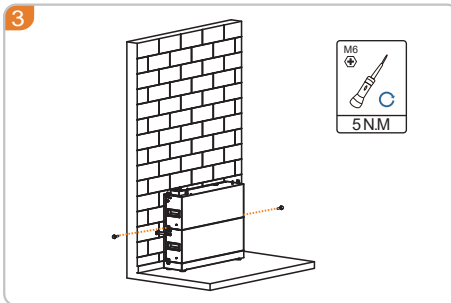
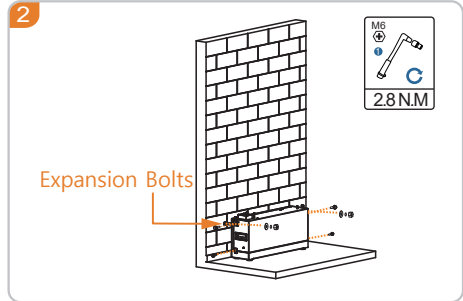
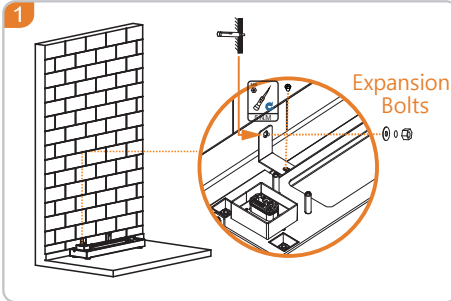

7 Refer to the electrical connection section for wiring

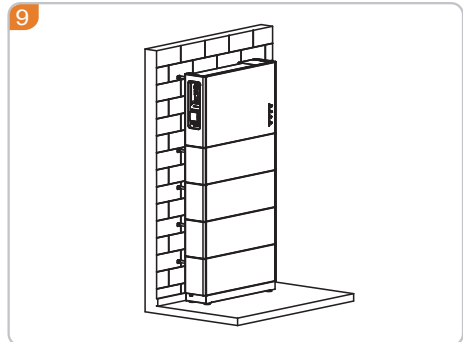
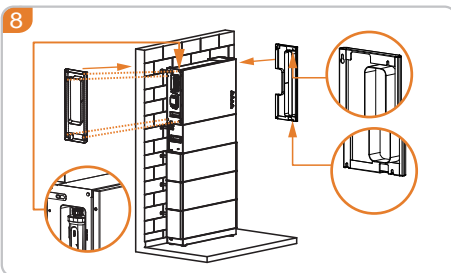

Port Instruction

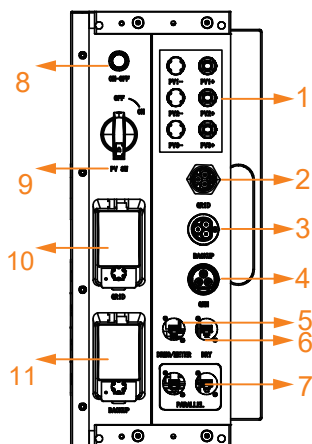

Items	Name
1	PV
2	GRID
3	BACKUP
4	GEN
5	DRMO / METER
6	DRY
7	PARALLEL
8	ON-OFF
9	PV SW
10	GRID BREAKER
11	BACKUP BREAKER
12	WIFI
13	BAT BREAKER
14	LED

PE Wiring

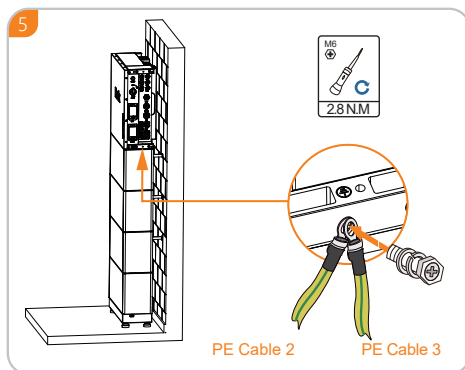
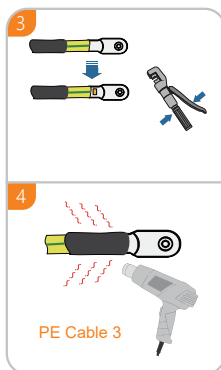
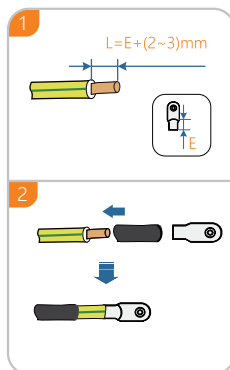

PV Connection

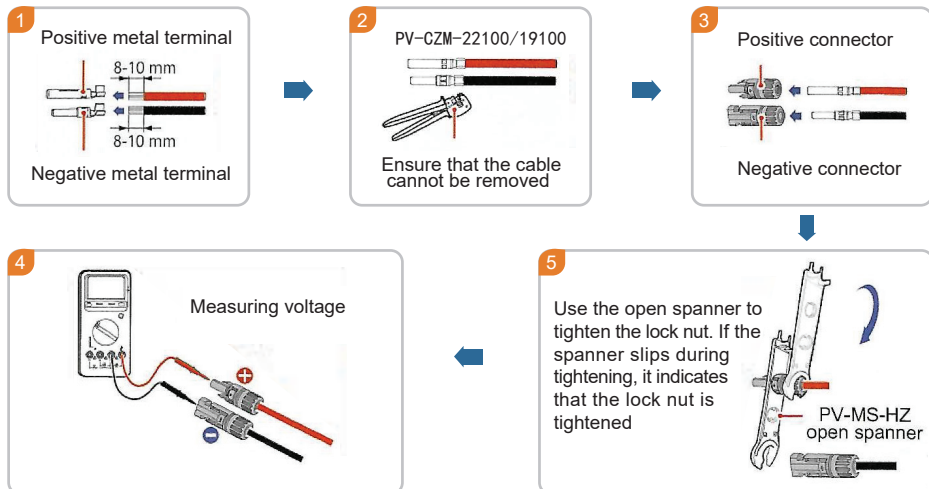

PV Arrays can be installed according to the needs of customers.
Each PV MPPT 120V-530V (550V, 16A, 3kW max).

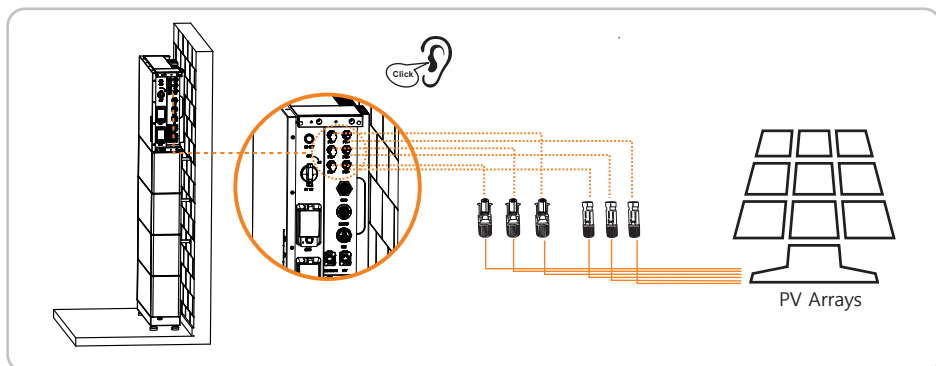

WiFi Dongle

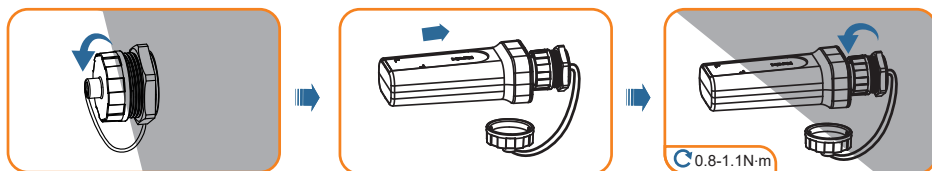

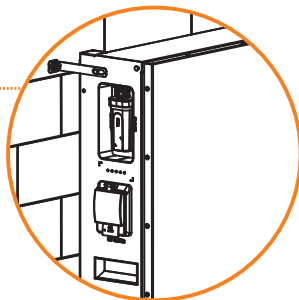
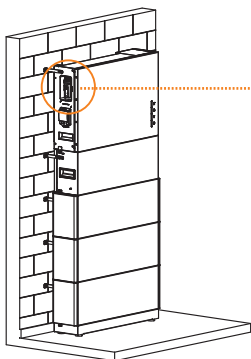

Tighten connector on the thread once Dongle is in.

Grid Connection

1

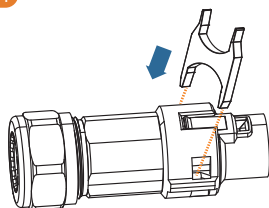

2

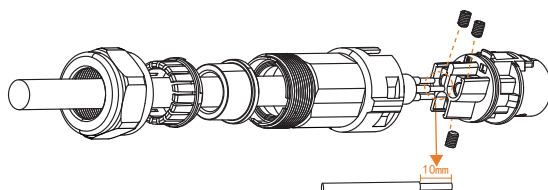

A

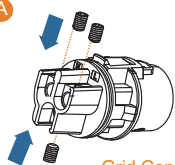

Grid Connector

B

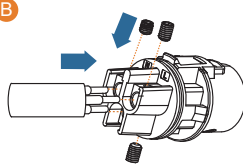

C

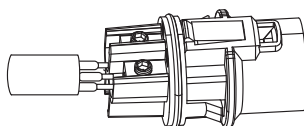

3

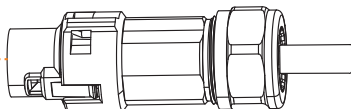
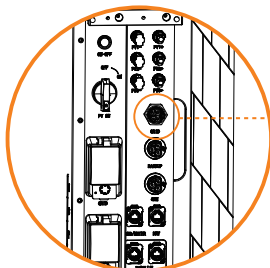

Load / Generator Connector

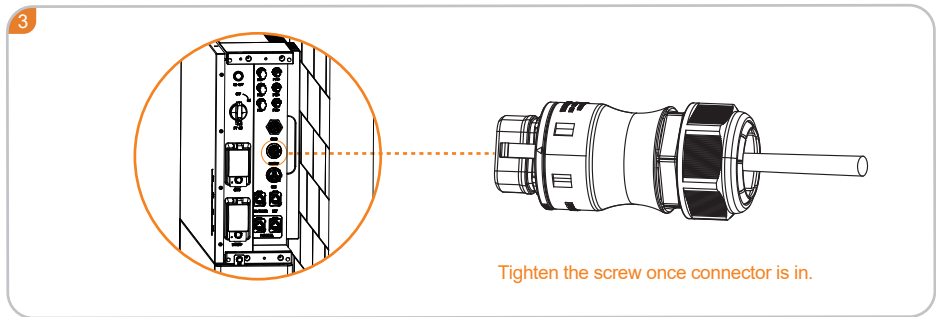
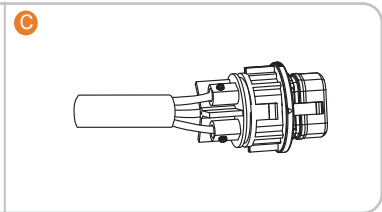
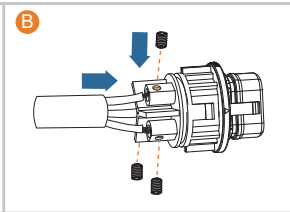
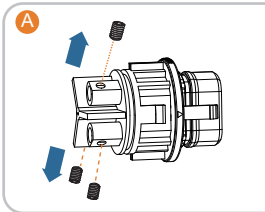
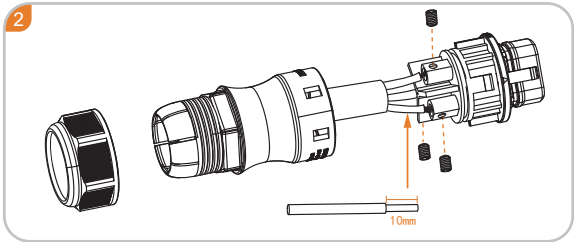
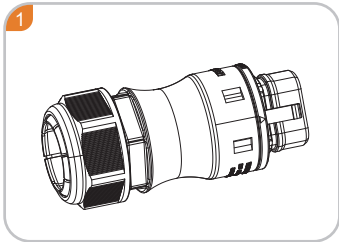

DRMO / METER, DRY, PARALLEL

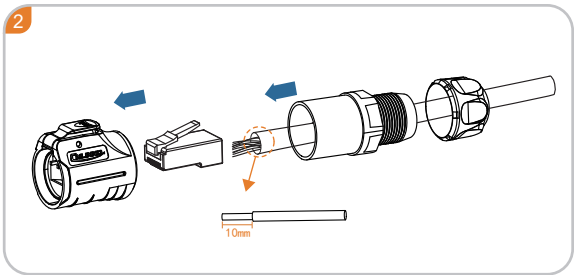
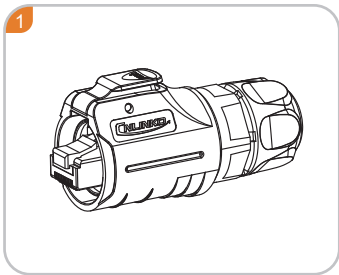

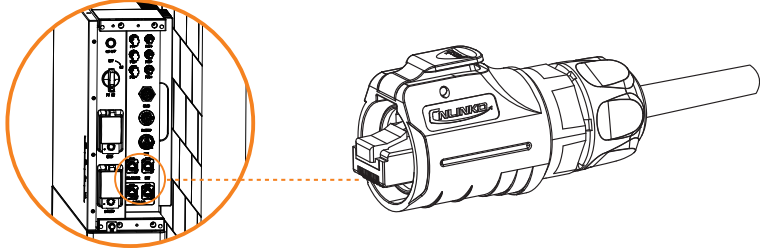

The dry contact is connected based on customer requirements

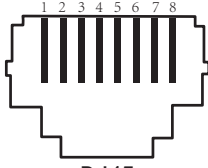
Dry Contact			
Connect with weak current			
Pin	Group	Definition	 RJ45
1	A1	NC	
2	A2	DRY_1_NC	
3	A3	NC	
4	A4	NC	
5	A5	DRY_1_COM	
6	A6	NC	
7	A7	NC	
8	A8	DRY_1_NO	

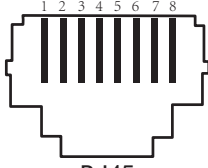
CT / Smart meter / DRM0			
Smart meter 485, DRM0 signal, external CT			
Pin	Group	Definition	 RJ45
1	A1	I_CT_IN-	
2	A2	I_CT_IN+	
3	A3	NC	
4	A4	485_C_A	
5	A5	485_C_B	
6	A6	NC	
7	A7	DMR0-	
8	A8	DMR0+	

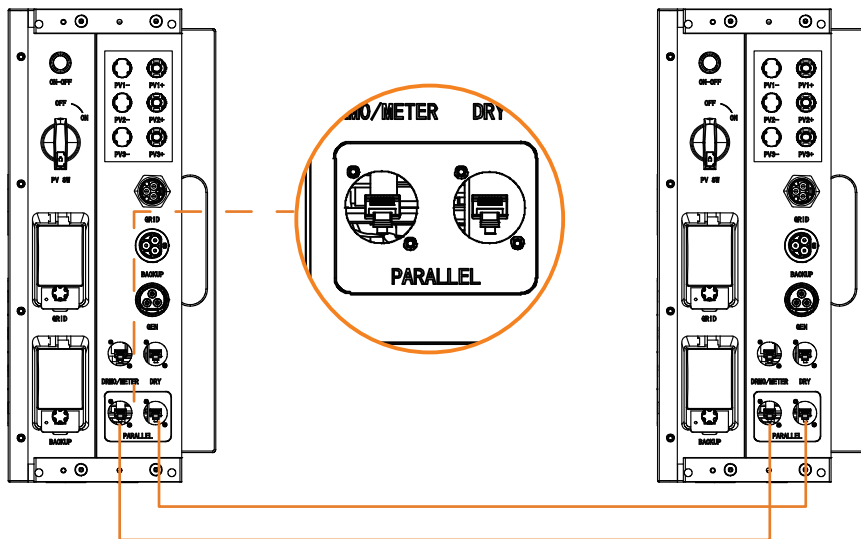

Network cable (8pin)

The parallel ports are RJ45 terminals and are connected using conventional 8 pin network cables



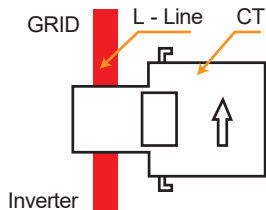
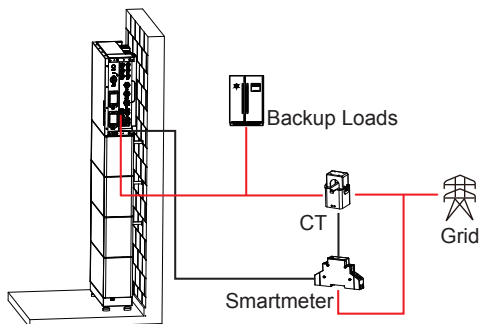

CT / Meter Installation

RX-7013Plus



The CT with the "GRID" label is attached to the L line of the power grid. The "GRID" CT arrow points towards the grid. The CT must be installed inside the switchboard. Refer to 240v diagram for more information.

LED Indicator

System Status	System Information	Display Logic			
		LED1 Battery	LED2 PV	LED3 Grid/Gen	Bi-colour LED4(Green/RED) Wifi/Ethernet/Fault
					
Normal Information	Power on	▲	▲	▲	▲
	Power off	■	■	■	■
	Promote update	/	/	/	
	Promote update success	★	★	★	★
Battery	Battery not connected	■	/	/	■
	Battery in & discharge	●	/	/	/
	Battery low (Battery in & discharge)	★	/	/	/
	Battery charge	■	/	/	/
PV	Battery fault	■	/	/	●
	PV not connected	/	/	/	/
	PV not connected & work	/	●	/	/
	PV fault	/	■	/	●
Grid-Generator	Grid-Generator not connected	/	/	/	/
	Grid-Generator in & work	/	/	●	/
	Grid-Generator fault	/	/	■	●
External Communication	Wifi-Ethernet not connected / Wifi-Ethernet	/	/	/	■
	Wifi-Ethernet connecting / Wifi-Ethernet				
	Wifi-Ethernet success connect & work/Wifi-Ethernet	/	/	/	●
Other important information	SOH low / SOH	/	/	/	■
	Permanent fault	■	■	■	■
	Idle	/	/	/	/
	System fault	/	/	/	●

Remark:

1、lamp-comment:

/: LED off/LED

●/●/●: LED on/LED

■/■/■: LED flash display-1Hz/LED-1Hz

★/★/★: LED flash display-2Hz/LED-2Hz

▲/▲/▲: LED light water display-2Hz/-2Hz

2、LED1/LED2/LED3/LED4 are displayed independently of each other during normal operation, and their functions can be stacked. If a fault is triggered, display it according to the faulty part.

LED1/LED2/LED3/LED4

SOC Led Indicate

Charging

SOC	L1 ●	L2 ●	L3 ●	L4 ●	L5 ●
0-20%	flash	off	off	off	off
21-40%	on	flash	off	off	off
41-80%	on	on	flash	off	off
61-80%	on	on	on	flash	off
81-100%	on	on	on	on	flash

Normal

SOC	L1 ●	L2 ●	L3 ●	L4 ●	L5 ●
0-20%	on	off	off	off	off
21-40%	on	on	off	off	off
41-80%	on	on	on	off	off
61-80%	on	on	on	off	off
81-100%	on	on	on	on	on

Notice

- If the startup fails, refer to "Troubleshooting" in the user manual.
- For details about LED indicators, refer to the user manual.

Description Of Energy Storage Capacity

13kWh
RX7013Plus

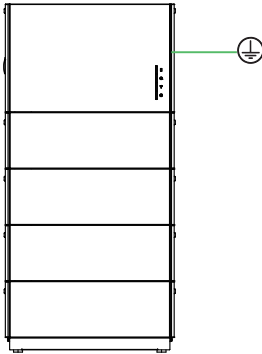

Inverter*1
Battery*4
Base*1



All Downloads



Warranty Registration



App Download

Power ™

The size and parameters of the product are subject to change without notice.

Rev 16.05.2024.



Helping power possibilities.
One system at a time.

Redx

In Technical Partnership with Redx

Power [™]

PowerPlus Energy Pty Ltd

2 Koornang Road

Scoresby, Vic, 3179

Australia

+61 3 8797 5557

info@powerplus-energy.com.au

powerplus-energy.com.au